

Raising the Bar on High Needs Specialized Education

OMAHA PUBLIC SCHOOLS TRANSITION PROGRAM

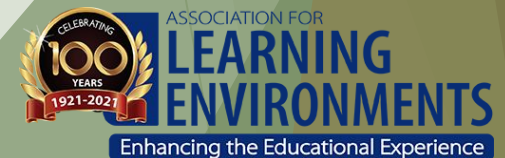

A4LE ASSOCIATION DAYS



Speakers



SHANA FRODYMA
OPS DIRECTOR
Transition and Work
Based Learning Program



MEGANNE LAMPRECHT
INTERIOR DESIGNER
BVH Architecture



CLEVE REEVES
PRINCIPAL ARCHITECT
BVH Architecture



HAILEE ABEGGLEN
ENGAGEMENT SPECIALIST
BVH Architecture



TIM FRISCH
GRAPHIC DESIGNER
BVH Architecture



A4LE ASSOCIATION DAYS



Agenda

- ▶ Overview of Transition Program
- ▶ Review the Planning Process
- ▶ Describe the Outcomes
- ▶ Student Engagement Highlight



A4LE ASSOCIATION DAYS

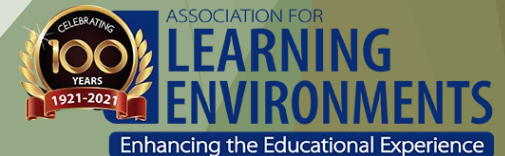

Transition Program Overview

- ▶ Transition Program
- ▶ Functional Life Skills Curriculum
- ▶ Program Growth



A4LE ASSOCIATION DAYS

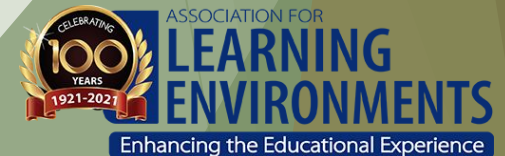



OPS Board/Bond Video



A4LE ASSOCIATION DAYS

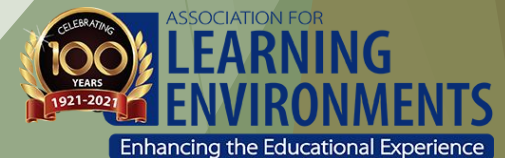

Planning Process Review

- ▶ Fast Timeline (2.5 months for design)
- ▶ Design Advisory Group (OPS Staff, Parents & Community Members)
- ▶ Completely Distinct to OPS, Usual Design Standards Did Not Apply

Guiding Principles

SET THE BAR HIGH. These students deserve better

Create a Conducive Environment for this Unique Population

- ▶ Space!
- ▶ Flow!
- ▶ Acoustics!
- ▶ HVAC!
- ▶ Technology!
- ▶ Movement/Recreation!
- ▶ Accessibility!

Create a “College Campus” for these Students



A4LE ASSOCIATION DAYS

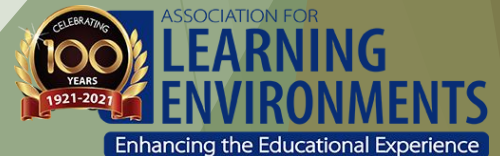

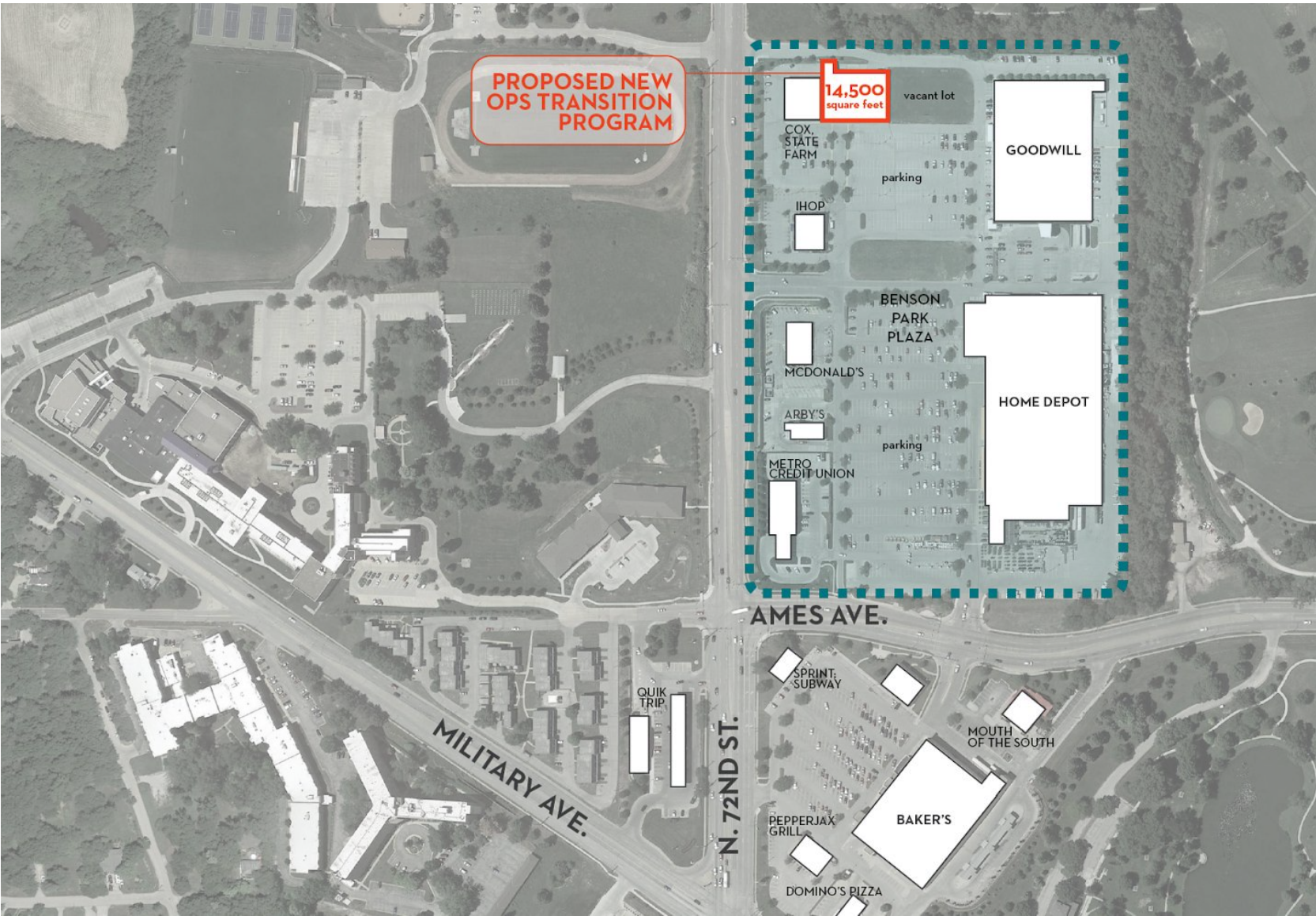

New Site

Former Fabrics Store

Near the previous location

Within a 2 mile radius of OPS High Schools and OPS Service Center

Location features convenient access and circulation and ample parking

Close access to several restaurants and businesses, such as Home Depot, Goodwill and Baker's Supermarket, which could offer work opportunities to the program's young adults

Building Reuse

14,500sf Available



A4LE ASSOCIATION DAYS

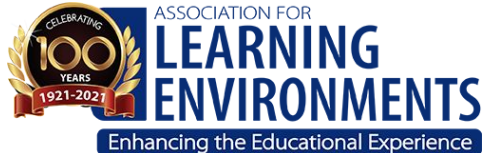

Program Fit

14,500sf Available
15,975sf Programmed

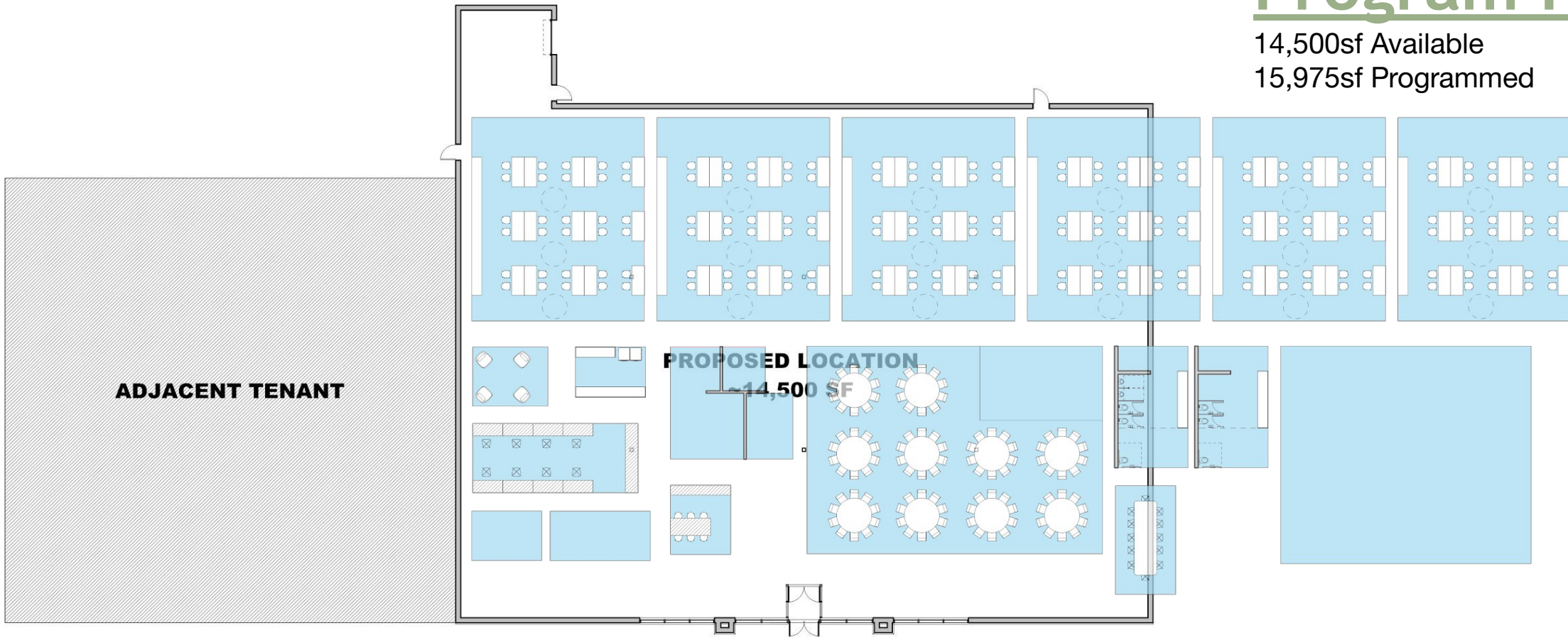

A4LE ASSOCIATION DAYS

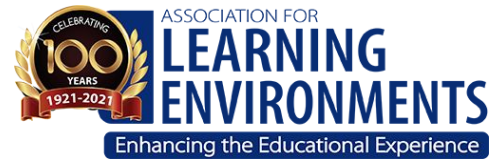

LEGEND

- | | | | | |
|------------------------|--------------------|-------------------|------------------|---------------|
| 1 Secured Lobby | 5 Women's Restroom | 9 Food Service | 13 Exercise Room | 17 Speech |
| 2 Changing Room | 6 Men's Restroom | 10 Loading | 14 Storage | 18 Office |
| 3 Daily Living/Laundry | 7 Nurse | 11 Small Training | 15 Sensory | 19 Conference |
| 4 Work/Break Room | 8 Cafeteria | 12 Technology | 16 Training | 20 Flex Zone |

Adjacent Tenants NIC



LEGEND

- | | | | | |
|------------------------|--------------------|-------------------|------------------|---------------|
| 1 Secured Lobby | 5 Women's Restroom | 9 Food Service | 13 Exercise Room | 17 Speech |
| 2 Changing Room | 6 Men's Restroom | 10 Loading | 14 Storage | 18 Office |
| 3 Daily Living/Laundry | 7 Nurse | 11 Small Training | 15 Sensory | 19 Conference |
| 4 Work/Break Room | 8 Cafeteria | 12 Technology | 16 Training | 20 Flex Zone |

Adjacent Tenants NIC



PROGRAM LEGEND

- ADMIN
- CLASSROOM
- MULTI-PURPOSE
- SERVICES



A4LE ASSOCIATION DAYS



LEGEND

- | | | | | |
|------------------------|--------------------|-------------------|------------------|---------------|
| 1 Secured Lobby | 5 Women's Restroom | 9 Food Service | 13 Exercise Room | 17 Speech |
| 2 Changing Room | 6 Men's Restroom | 10 Loading | 14 Storage | 18 Office |
| 3 Daily Living/Laundry | 7 Nurse | 11 Small Training | 15 Sensory | 19 Conference |
| 4 Work/Break Room | 8 Cafeteria | 12 Technology | 16 Training | 20 Flex Zone |

Adjacent Tenants NIC

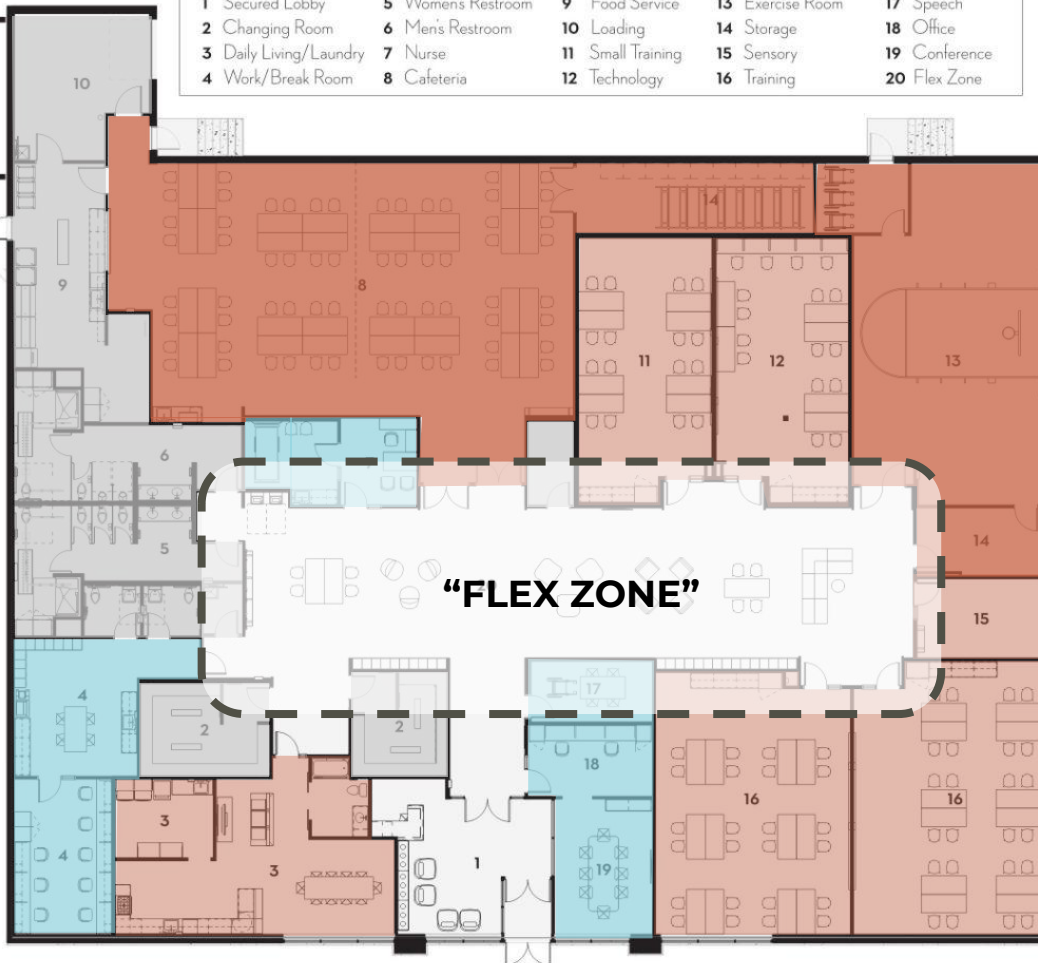

PROGRAM LEGEND

- ADMIN
- CLASSROOM
- MULTI-PURPOSE
- SERVICES





A4LE ASSOCIATION DAYS

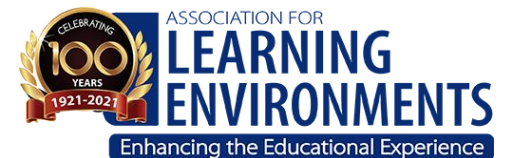



A4LE ASSOCIATION DAYS





A4LE ASSOCIATION DAYS









A4LE ASSOCIATION DAYS

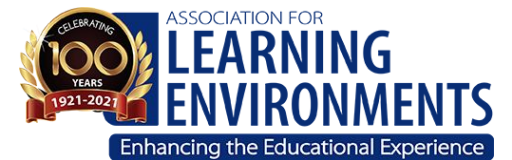



A4LE ASSOCIATION DAYS

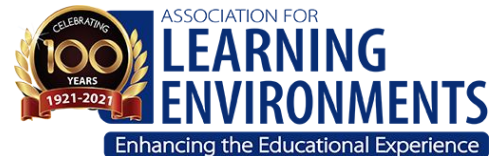

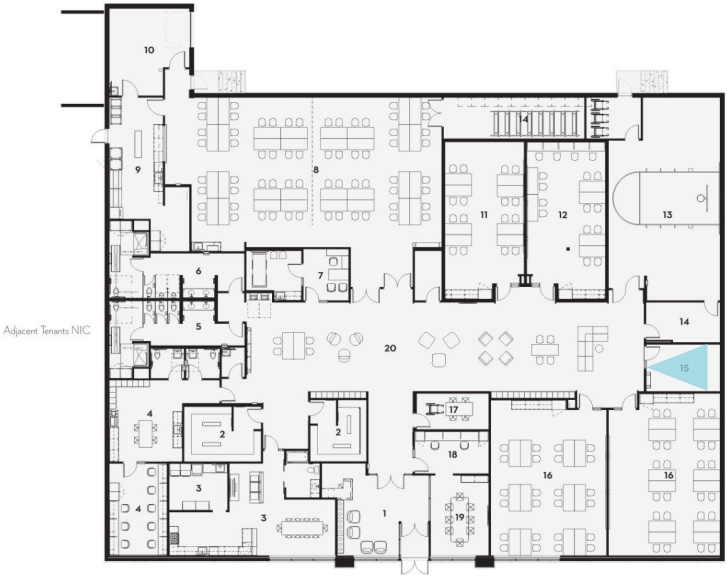



A4LE ASSOCIATION DAYS

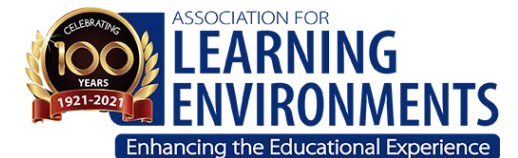

Health & Wellness

SET THE BAR HIGH. Design for optimum learning conditions.

- ▶ Interior Finishes Selected for Cleanability and Durability
- ▶ Healthy Electrical Design
 - ▶ Circadian Lighting Design: Color Tuning, Intensity Tuning, Stimulus Tuning
 - ▶ Sound Masking in Classrooms, Flex Zone, Multipurpose Room, Sensory Room, and Cafeteria
- ▶ Healthy Mechanical Design
 - ▶ UV Disinfection on Cooling Coils to Prevent Microbial Growth
 - ▶ Electronic Air Cleaners in Main Return Air Ducts
 - ▶ Increased Outdoor Air Ventilation and Filtration with Energy Recovery Ventilators (ERVs)
 - ▶ Dedicated Exhaust Systems at Restrooms, Changing Rooms, and Nurse Areas



A4LE ASSOCIATION DAYS



Health & Wellness

SET THE BAR HIGH. Design for optimum learning conditions.

- ▶ Restroom and Nurse Room Design
 - ▶ Bariatric Fixtures
 - ▶ Hoyer Lift in Restrooms for Extra Student Assistance
 - ▶ Zero Entry Showers in Restrooms
 - ▶ Diaper Disposal Areas with Dedicated Exhaust System
 - ▶ Dedicated Staff Restrooms
 - ▶ Dedicated Sick Room off of Nurse Room

OPS Outcomes

- ▶ Healthy space = Healthy students
- ▶ Having the majority of our students in the same building is AMAZING!
 - ▶ Teacher, student and family engagement very high in this location.
- ▶ Lower absenteeism than rest of OPS during pandemic
- ▶ Sets the bar for OPS inclusive learning environment
- ▶ Staff/student morale extremely high



A4LE ASSOCIATION DAYS

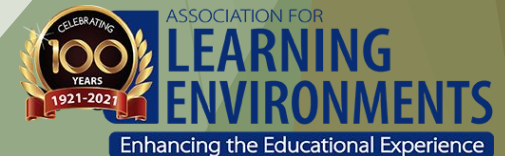

Student Engagement

- ▶ Creating something that goes outside of the classroom
- ▶ Bring students into our creative process
- ▶ Engage with our true clients



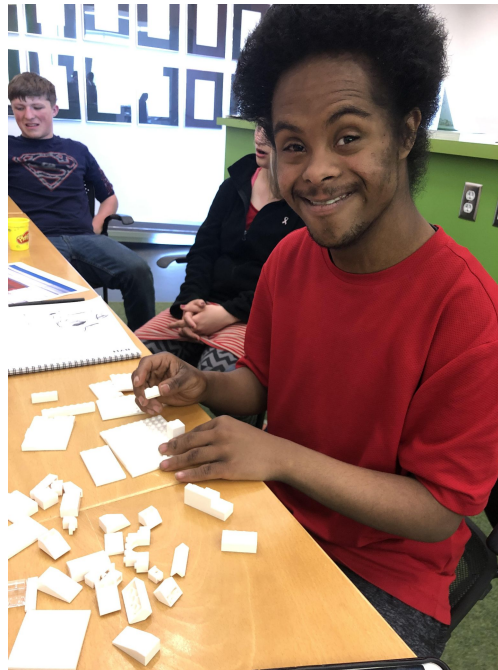
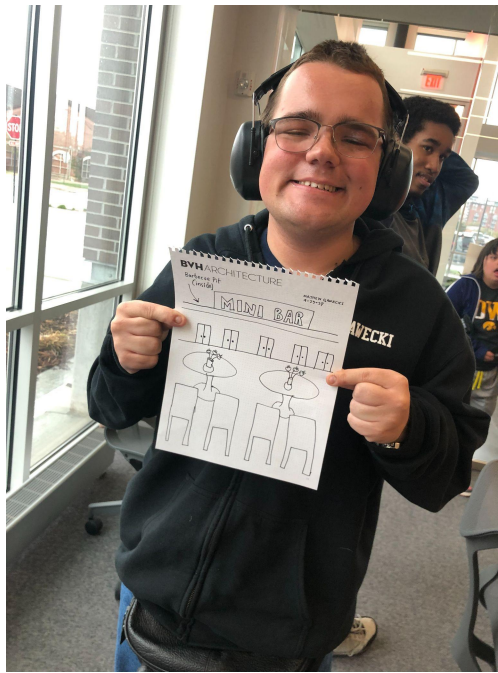





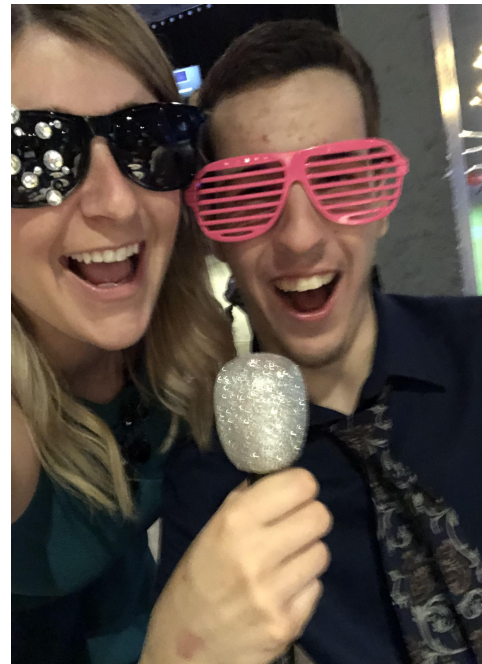

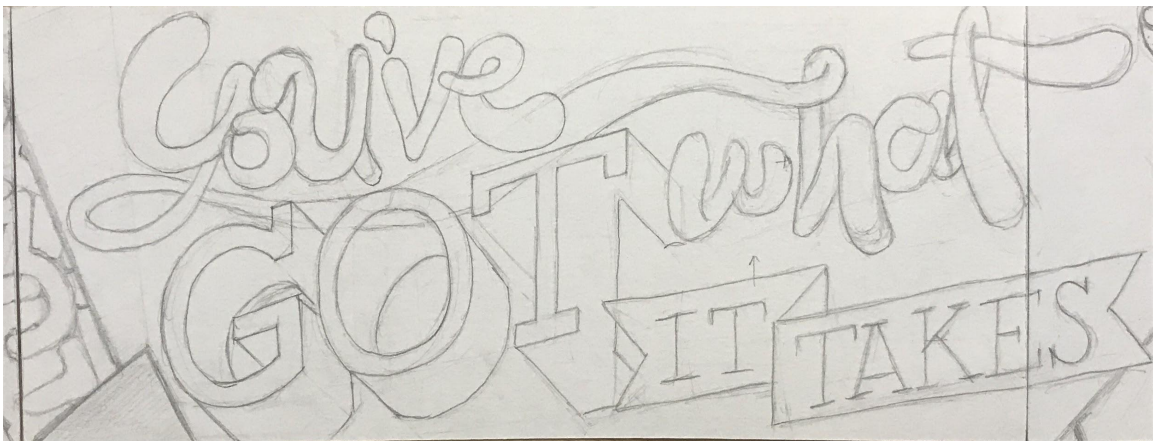
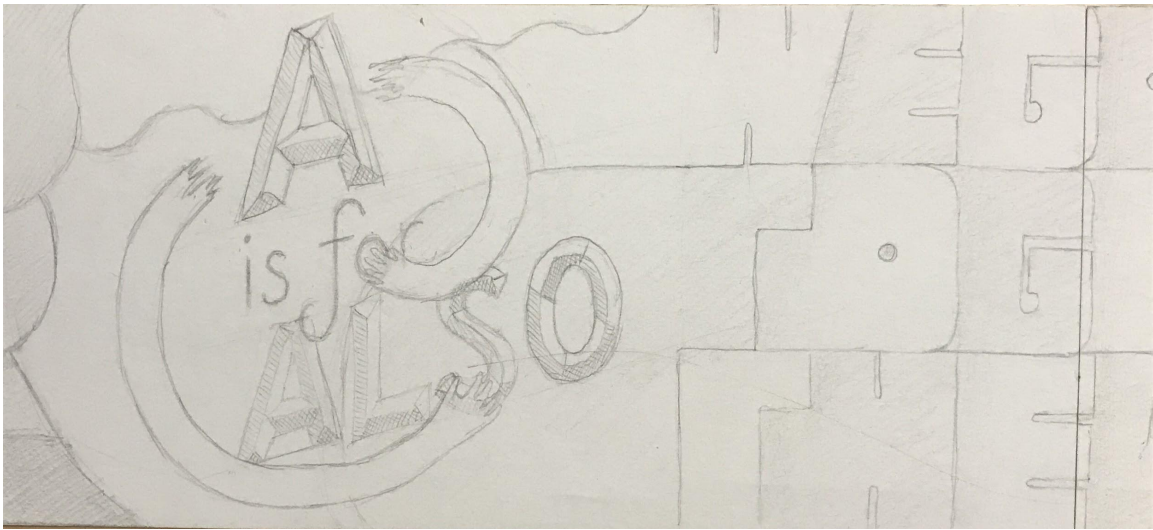

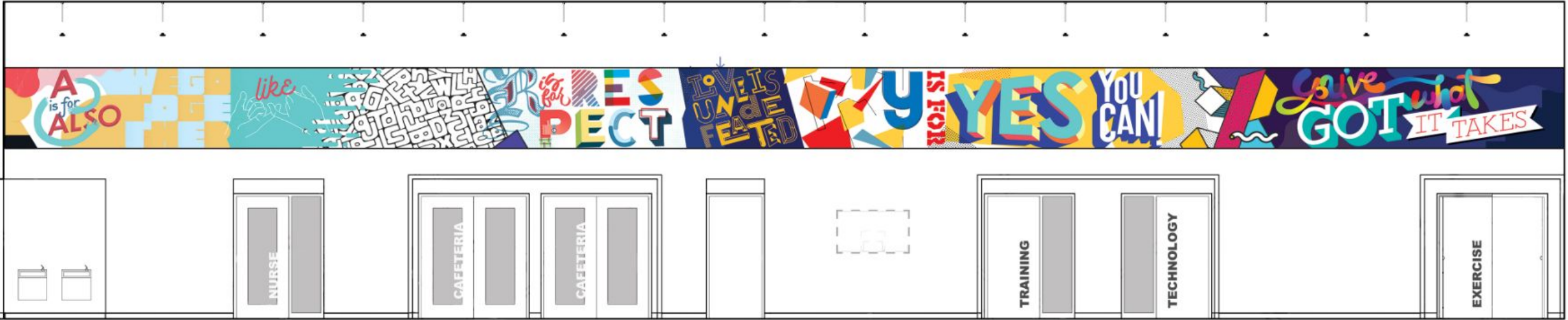



Raising the Bar on High Needs Specialized Education

OMAHA PUBLIC SCHOOLS TRANSITION PROGRAM

CONTACT US WITH QUESTIONS:

Shana Frodyma
shana.frodyma@ops.org
531.299.9490

Cleve Reeves, AIA
creeves@bvh.com
402.325.1509



A4LE ASSOCIATION DAYS

